

INSTRUCTION SHEET

SmartAXIS

Communication Cartridge

Confirm that the delivered product is what you have ordered. Read this instruction sheet, FT1A Instruction sheet and FT1A Series User's manual to make sure of correct operation. Make sure that the instruction sheet is kept by the end user.

SAFETY NOTE

In this operation instruction sheet, safety precautions are categorized in order of importance to Warning and Caution :

WARNING

Warning notices are used to emphasize that improper operation may cause severe personal injury or death.

- Turn off power to the SmartAXIS before installation, removal, wiring, maintenance, and inspection of the Communication Cartridge. Failure to turn power off may cause electrical shocks or fire hazard.
- Special expertise is required to install, wire, program, and operate the Communication Cartridge. People without such expertise must not use the Communication Cartridge.
- Install the Communication Cartridge according to this instruction sheet and FT1A Series User's manual. Improper installation will result in falling, failure, or malfunction of the SmartAXIS.

CAUTION

Caution notices are used where inattention might cause personal injury or damage to equipment.

- The Communication Cartridge is designed for FT1A series. Do not connect with other products.
- Install the Communication Cartridge in environments described in FT1A series User's manual.
- The Communication Cartridge contains electronic parts. When disposing of the Communication Cartridge, do so in accordance with national and local regulations.

1 Unpacking

Before installing the Communication Cartridge, make sure that following items are contained completely without damage during transportation.

Item	Specification	Type Number	Number
Communication Cartridge	RS232C, mini DIN connector type	FT1A-PC1	1 for each
	RRS485, mini DIN connector type	FT1A-PC2	
	RS485, terminal type	FT1A-PC3	

Remove the expansion communication port cover by inserting a flat screwdriver into the slots at the top and bottom of the SmartAXIS, pressing in the tabs at either end of the cover, and lifting it directly upward.

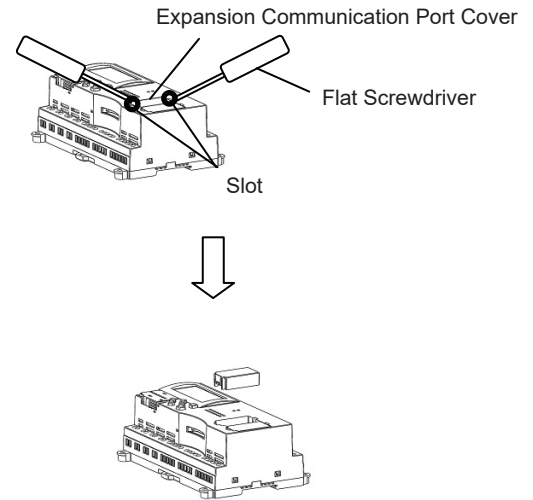

After removing the expansion communication port cover, carefully install the communication cartridge on the SmartAXIS expansion communication port. Ensure that the cartridge is installed with the correct orientation.

With communication cartridges installed.

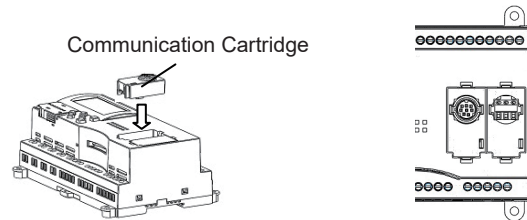

SmartAXIS User's manual can be downloaded from https://us.idec.com/c/SmartAXIS_FT1A